



Walton Arts Center

# Technical Package



## Starr Theater

Revision 16.3.2 – September 3<sup>rd</sup>, 2025



# Walton Arts Center

## Starr Theater

### Technical Information Package

<u>Administrative Offices (shipping):</u>	255 N School Ave, Fayetteville, AR 72701
<u>Stage Door/Loading Dock (freight):</u>	495 W Dickson St, Fayetteville, AR 72701
<u>Billing:</u>	PO Box 3547, Fayetteville, AR 72702-3547
<u>Main Phone:</u>	479-443-9216
<u>Box Office Phone:</u>	479-443-5600
<u>Website:</u>	<a href="http://waltonartscenter.org">waltonartscenter.org</a>

**For ALL incoming USPS/UPS/FedEx packages, please use Administrative Offices. All packages will be signed for by the front desk receptionist, logged, and delivered to stage level by venue staff.**

**Packages are not delivered by carriers on Saturday or Sunday, so please arrange shipments accordingly.**

**Walton Arts Center DOES NOT have a shipping and receiving department. Outgoing package arrangements must be made with a carrier directly and must be communicated to Walton Arts Center staff so it can be placed in the appropriate location. The administrative offices are closed outside normal business hours and pickups will not be made.**

**The Administrative Offices must be used as the pickup location for all outgoing packages not handled directly by tour personnel.**

**All freight must use the Loading Dock address.**

## **Contents**

Contact Information .....	6
Production Staff.....	6
Technical Director .....	6
Assistant Technical Director.....	6
Artist Services Specialist .....	6
Director of Production Administration .....	6
Senior Production Coordinator .....	6
Programming .....	6
Director, Programming .....	6
Front of House.....	6
Box Office.....	6
Box Office Manager .....	6
Driving Directions.....	7
Company Management .....	8
Green Room and Dressing Rooms (see “Appendix E - Photos” – page 26) .....	8
Production Office .....	8
Stage Manager’s Console .....	8
Local Crew .....	8
Access for People with Disabilities.....	8
Policies .....	8
Labor Rates & Crew Policies .....	9
Carpentry .....	10
Loading Dock (see “Appendix E - Photos” – page 26).....	10
Stage Dimensions .....	10
Stage Floor.....	10
Soft Goods .....	10
Seating Capacity .....	10
Props .....	11
Music.....	11
Platforms/Riser Decks.....	11
Lectern .....	11

Dance Floor .....	11
Electrics .....	12
Instrument Inventory .....	12
Control Console .....	12
House Lights (controlled via DMX universe 1) .....	12
Dimmers (controlled via DMX universe 1) .....	12
Company Switch .....	12
Cabling .....	12
Miscellaneous .....	12
Circuit and Dimmer Schedule .....	12
Audio .....	13
Control Location .....	13
Production Communications .....	13
Mixing Console .....	13
Fixed Speakers .....	13
Power Amps .....	13
Wireless Mics .....	13
Wardrobe .....	14
Wardrobe Area (see “Appendix E - Photos” – page 32) .....	14
Laundry Room (see “Appendix E - Photos” – page 32) .....	14
Appendix A – Supplemental Audio Inventory .....	15
Mics .....	15
Direct Boxes .....	16
Portable Consoles .....	16
Portable Speakers* .....	16
Foldback Speakers* .....	16
Cable .....	16
Appendix B – Supplemental Video Inventory .....	17
Projectors .....	17
Projector Lenses .....	17
Projection Screens .....	17
Video Switchers .....	17
Signal Conversion .....	17

Content Sources .....	17
Video Cable .....	17
Displays.....	18
Display Stands .....	18
Appendix C – Instrument Inventory .....	19
Drums.....	19
Percussion.....	19
Piano/Keys .....	20
Strings .....	20
Miscellaneous.....	20
Appendix D – Ground Plans & Layouts.....	21
Walton Arts Center Facility – Floor Plan – Level 1 .....	21
Walton Arts Center Facility – Floor Plan – Level 2.....	22
Starr Theater – Empty Layout.....	23
Starr Theater – Catwalk Layout.....	24
Starr Theater – Seating Layout.....	25
Appendix E - Photos.....	26
Venue Truck Entrance .....	26
Venue Loading Dock .....	26
Starr Theater – Stage Area .....	27
Starr Theater – Fully Deployed Seating .....	27
Starr Theater – Fully Retracted Seating .....	28
Starr Theater – Green Room .....	28
Starr Theater – Large Dressing Room .....	29
Starr Theater – Small Dressing Room .....	29
Interior Loading Dock View .....	30
Stage View from Loading Dock.....	30
Additional Storage – “Boneyard” .....	31
“Boneyard” – Alternate View .....	31
Wardrobe Room.....	32
Laundry Room.....	32
Visiting Production Office.....	33

## **Contact Information**

### **Production Staff**

#### **Technical Director**

Alex Newby  
Office: 479-571-2736  
[anewby@waltonartscenter.org](mailto:anewby@waltonartscenter.org)

#### **Assistant Technical Director**

Josh Spurgers  
Office: 479-571-2713  
[jspurgers@waltonartscenter.org](mailto:jspurgers@waltonartscenter.org)

#### **Artist Services Specialist**

Kayli Patterson  
Office: 479-571-2786  
[kpatterson@waltonartscenter.org](mailto:kpatterson@waltonartscenter.org)

#### **Director of Production Administration**

Cody Kopp  
Office: 479-571-2701  
[ckopp@waltonartscenter.org](mailto:ckopp@waltonartscenter.org)

#### **Senior Production Coordinator**

Hali Pinson  
Office: 479-571-2711  
[hpinson@waltonartscenter.org](mailto:hpinson@waltonartscenter.org)

### **Programming**

#### **Director, Programming**

Curt Owens  
Office: 479-316-7509  
[cowens@waltonartscenter.org](mailto:cowens@waltonartscenter.org)

### **Box Office**

#### **Box Office Manager**

Rachael Schneider  
Office: 479-316-7381  
[acrowe@waltonartscenter.org](mailto:acrowe@waltonartscenter.org)

### **Front of House**

#### **Senior Manager, Patron Services**

Nathan Bell  
Office: 479-571-2744  
[nbell@waltonartscenter.org](mailto:nbell@waltonartscenter.org)

For local hospitality and lodging information, please contact the **Artist Services Specialist**.

Fayetteville, Arkansas is located in the Northwest corner of Arkansas in the **Central Time Zone**.

## **Driving Directions**

### **Walton Arts Center – Fayetteville, Arkansas - 479-443-9216**

- **From the South:** From I-40 take I-49 North at Alma, Arkansas.
- **From the North:** From I-44 take US-71 South at Joplin, Missouri (it will turn into I-49 in Bentonville, Arkansas).
- **From the West:** From I-44 take US-412 East at Tulsa, Oklahoma. Turn South at I-49 in Springdale, Arkansas.
- **From the East:** The two options are I-40 and I-44; see above.

Once on **I-49**, take **EXIT 62** which is also US-62.

**Turn East** and continue **1.8 miles** to a traffic light at the intersection with **School Avenue** (O'Reilly Auto Parts and Walgreen's at the intersection).

**Turn left on School Avenue.** Go **0.9 mile** on a curved, 4-lane uphill through a double "S", continuing to the intersection with **Dickson Street** (Washington County Courthouse on your right).

**Turn left on Dickson Street.** Go downhill **0.4 mile** to the traffic light at the intersection with **West Avenue** and **turn left**. The WAC is on the corner to your left. The **first driveway on your left** will line you up to back into our loading dock.

Ample public parking is available across the street to the West of the theater. Arrangements can be made for onsite or offsite bus, truck, and trailer parking based on the needs of the production.

***Please forward these directions to your transportation captain or lead driver.***



## **Company Management**

### **Green Room and Dressing Rooms (see “Appendix E - Photos” – page 26)**

The green room and dressing rooms are located upstairs, accessible from the USR loading doors and via elevator. There are 2 dressing rooms, each with shower and restroom facilities. One dressing room has 10 stations and the other has 5 stations.

### **Production Office**

The production office is a dedicated touring production office, located just inside the stage door. Availability is contingent on use from the main hall (Baum Walker Hall). If the main hall is empty or the resident company does not require it, it will be made available to companies residing in Starr Theater.

### **Stage Manager's Console**

The stage managers console is typically located in the SR hallway, and includes both wired and wireless Clear-Com, a video monitor, and paging to all theater spaces. It can be located onstage or in the tech booth, if preferred.

### **Local Crew**

The Director of Production and department heads are full-time Walton Arts Center staff. Local stagehands are non-union and are employed by Walton Arts Center on an as-needed basis. All crew sizes, skills, and specialties are available on request and per contract negotiations with advanced notice. Most local crew members are cross-trained and can switch departments as required.

### **Access for People with Disabilities**

All backstage areas are accessible to people with disabilities. All spaces are on the same level except for the orchestra pit, which is equipped with a stair lift. All front-of-house and patron areas are ADA compliant.

### **Policies**

- House opens at one half hour before curtain.
- Walton Arts Center does not provide alcohol for staff, cast, or crew. However, companies may bring their own alcohol.
- The entire building is non-smoking, including the exterior loading dock and an 85' radius from every entrance. The smoking area is located outside the loading dock.
- Badges/laminates are to be worn at all times.
- The building curfew is 11:00 PM on weekdays and 12:00 PM on weekends. This is subject to change based on the needs of the show.
- The stage door can be accessed beginning at 8:00 AM. This is subject to change based on the needs of the show.
- Walton Arts Center reserves the right to restrict operation of house equipment to Walton Arts Center personnel. Walton Arts Center reserves the right of final approval on all rigging, pyrotechnic, and/or safety issues.
- Hard hats require while riggers working overhead.
- Maximum allowable level is 95 dBA average measured at mix position.



## **Labor Rates & Crew Policies**

### **Rates**

- Stagehands: \$32/hr
- Up Rigger: \$57/hr
- Down Rigger: \$52/hr

### **OT Rules**

- **1.5x** after 40 hours worked on the week.
- **1.5x** for hours worked between midnight-5:59 a.m., or on an observed holiday.
- **2x** for hours worked over 40 hours during midnight time or on an observed holiday.
- **3x** for hours worked over 40 hours during midnight time **and** on an observed holiday.

### **Labor Policies:**

- All calls are subject to 4-hour minimum calls. If two shifts are scheduled more than 8 hours apart (meaning there is 8 hours between the end of a shift and the beginning of a new one), each shift is subject to a new 4-hour minimum.
- All crew that work more than 5 consecutive hours in a shift must be given a 1-hour walkaway break. If a break of that duration cannot be provided, then a catered 30-minute break on the clock must be provided. If a catered meal cannot be provided, then a meal penalty of 1 hour at 2x the stagehand rate will be charged for all crew affected.
- When rigging is needed, a minimum of 3 riggers (2 up, 1 down) is required.
- Fly-rail operators will be charged the down rigging rates while rigging work is being done.
- Departments can cross over into other areas.
- Cancellations must be at least 24 hours in advance. Cancellations less than 24 hours of a scheduled call will result in a 4-hour minimum call being charged for each cancelled crew member.
- Labor requests less than a week in advance are subject to availability.
- Walton Arts Center Production has final authority on all matters pertaining to the Local Stagehand Crew.

Any questions regarding labor or billing rates can be directed to **Director of Production Administration**.

## **Carpentry**

### **Loading Dock (see “Appendix E - Photos” – page 26)**

Loading dock can hold 2 tractor/trailers.

Dock exterior walking surface is 35' x 10' and covered.

Truck height is 4' 0" high by 23' wide.

Bobtail dock is 1' 10" high by 11' 9" wide.

[2] loading doors, each 10' 7" high by 7' 9" wide

[2] 50A, 120'208V, 1Ø receptacles (NEMA B-33) available for shore power

Distance from dock to theater is approximately 50' at stage level.

**LOADING DOCK IS NOT AIR CONDITIONED.** Any wardrobe/quick-change setup in the dock will be subject to temperature fluctuations due to local weather conditions. Operation of steamers and dryers in dock will result in uncomfortable warmth during warmer weather. The dock is heated, so temperatures are more manageable in winter months.

### **Stage Dimensions**

Bare space is 57' 7" wide by 63' 9" deep.

Retractable stadium seating permanently installed in north wall.

The seating system can be deployed as 3 rows, 6 rows, 9 rows, or all 11 rows.

Each row is approximately 3' 6" deep and contains 21 chairs.

The south wall has a large picture window with blackout curtain.

The window is 30' wide by 12' high.

The catwalk height is 19'.

The loading door opening is 12' tall by 7' wide.

### **Stage Floor**

Sprung surface, black semi-gloss painted Masonite surface. No traps. Deck screws only.

### **Soft Goods**

[2] Tabs (black Encore) - 24' wide, sewn flat.

[4] Legs (black Encore) – 12' wide, sewn flat.

[1] Star Drop (black Encore, white 8ch LED) – 48' wide, sewn flat.

[1] Cyclorama (white Leno) – 48' wide, seamless.

All soft goods are 20' tall.

Room is equipped with SL and SR traveler track with 16' tall black Encore panels sewn 50% full. There is also an upstage traveler track against the south wall covering the picture window. Additional soft goods are available as required.

### **Seating Capacity**

[231] Collapsible Bleachers (Chairs and/or cocktail tables as required)

The maximum occupancy of the room is 250. However, this is for a combination of bleacher and cabaret-style seating typically used for small ensemble concerts. Due to the highly flexible nature of Starr Theater, a wide variety of seating configurations are possible, each with its own regulatory limitations. Actual capacities can be determined on an individual basis based on the production's needs and are subject to approval by Walton Arts Center management and the Fayetteville Fire Marshall.

## **Props**

### **Music**

- [100] Wenger orchestra chairs (black, assorted heights)
- [67] Wenger music stands (black)
- [61] Music stand lights (incandescent, dimmable upon request)
- [1] Wenger conductor's music stand
- [1] Wenger conductor's podium (two-levels at 6" and 12" heights)

### **Platforms/Riser Decks**

- [24] Wenger Versalite decks (4' by 8')
- [144] Adjustable legs (18"-40" height range)
  - Fixed legs also available in 8" increments.
  - Additional risers and legs available when required
  - Velcro skirts available at 8", 16", and 24". (approximately 120 running feet each)

### **Lectern**

- [1] WAC branded lectern (birch and silver, 2' wide by 4' high)

### **Dance Floor**

Harlequin reversible dance floor (black/white, semi-gloss, rolls 6'6" wide)

- [5] 65' long rolls
- [1] 58' long roll
- [5] 41' long rolls

## Electrics

### Instrument Inventory

- [50] Source Four Junior Zooms
- [25] Source Four PAR (VNSP, NSP, MFL, and WFL lenses in stock)
- [25] Source Four PARnel
- [8] Fixed LED curtain warmers (along east/west walls)

### Control Console

- [1] ETC IonXE20 with two touchscreen monitors.

### House Lights (controlled via DMX universe 1)

Digital control from FOH lighting booth, with optional control from HL or audio position.

### Dimmers (controlled via DMX universe 1)

- [96] 2.4 kW ETC Sensor D20AF modules

### Company Switch

120/208V; 3Ø; 200A; company switch located just outside SR loading door.

### Cabling

- [15] 5' 12/3 2P&G/stage pin
- [15] 10' 12/3 2P&G/stage pin
- [15] 25' 12/3 2P&G/stage pin

### Miscellaneous

- [1] Genie AWP-36 personnel lift – 36' lift

### Circuit and Dimmer Schedule

Outlet Location	2.4 kW / 20 A Dimmers	2.4 kW / 20 A Relays
Catwalk 1 (booth)	1-18	200-202
Catwalk 2	19-42	203-208
Catwalk 3	43-66	209-214
Catwalk 4	67-90	215-220
Catwalk 5	91-120	221-227
Catwalk 6 (window)	121-144	228-235
HL wall	145-148	236
DSR wall	149-154	237
USR wall	155-160	238-239
HR wall	161-164	240
DSL wall	165-170	241
USL wall	171-176	242-243
Lighting Booth	177-178	244-245

**ALL DIMMER CONNECTORS ARE 20 AMP 2P&G / STAGE PIN  
ALL RELAY CONNECTORS ARE 20 AMP EDISON / NEMA 5-20R**

## **Audio**

### **Control Location**

18' 8" wide by 8' 3" deep mezzanine-level booth in rear of house (6' off-center right)

### **Production Communications**

- [1] Clear-Com MS-702 2-channel main station
- [4] RS 701 2-channel belt packs
- [1] Clear-Com F1-1 call flasher
- [1] Clear-Com handset phone
- [1] HME DX210 wireless base station
- [4] HME BP200 wireless belt packs

### **Mixing Console**

Yamaha CL1-1 console with Yamaha Rio 3224-D (32in/16out XLR stage box)

### **Fixed Speakers**

- [4] Nexo GEOS 1210 full range speakers
- [2] Nexo GEOS 1230 full range down-fill speakers
- [2] Nexo LS18 subwoofer

### **Power Amps**

- [1] Nexo NXAMP 4x4

### **Wireless Mics**

- [1] Shure ULXD4D 2-channel wireless receiver
- [2] Shure ULXD2 handheld transmitters w/ Shure Beta87a capsules
- [1] Shure ULXD1 body pack transmitter

Starr Theater is equipped with almost limitless liquidity to patch audio, SDI video signal, and CAT6 networking throughout the entire room.

The equipment listed above is assigned to Starr Theater. Additional resources may be available. Please see Appendix A (page 15) for a list of other inventory.

**Maximum sound levels are closely monitored.**

**Walton Arts Center will have final approval on all levels.**

## **Wardrobe**

### **Wardrobe Area (see “Appendix E - Photos” – page 32)**

967 square foot wardrobe room located just inside stage door.

- [10] 20A electrical circuits (NEMA 5-20R)
- [10] rolling racks
- [5] steamers
- [5] irons
- [5] ironing boards
- [2] sinks with spray wands
- [1] sewing table and heavy duty machine

This room does not have direct access to outside ventilation. This room is approximately 150' from the dressing room hallway and SL entrance.

The main hall (Baum Walker Hall) takes precedent for wardrobe room usage when both venues are in use.

Quick change booths are available. (pipe and drape or flats)

### **Laundry Room (see “Appendix E - Photos” – page 32)**

200 square foot laundry facility

- [2] standard capacity washers (Samsung MODEL NO. WF36J4000AW/A2)
- [2] standard capacity dryers (Samsung MODEL NO. DV36J4000EW/A3)
- [1] high capacity washer (Samsung MODEL NO. WF56H9100AW/A2)
- [1] high capacity dryer (Samsung MODEL NO. DV56H9100EW/A2)
- Electrical and water for additional W/D hookup in room.*
- [2] deep basin utility sinks
- [2] 6' tables of sorting space

The main hall (Baum Walker Hall) takes precedent for laundry room usage when both venues are in use, however at least 1 washer and 1 dryer will be made available.

## **Appendix A – Supplemental Audio Inventory**

Baum Walker Hall needs take precedent for use of this equipment.  
All equipment availability and use subject to advance.

### **Mics**

[14]	Shure SM58
[9]	Shure SM57
[1]	Shure SM81
[1]	Shure Beta 52A
[1]	Shure Beta 57A
[1]	Shure Beta 91
[3]	Shure Beta 98
[4]	Shure Beta 87A wireless
[2]	Shure SM58 wireless
[2]	Shure MX405 w/ pre-amp MX400DP
[1]	Shure WL93
[1]	Shure WL184
[2]	Shure WL185
[2]	Shure KSM 32
[2]	AKG C414B
[5]	AudioTechnica AT Pro 45
[2]	AudioTechnica AT835
[2]	AudioTechnica AT 4050
[4]	AudioTechnica AT4041
[1]	Beyerdynamic M88TG
[4]	Countryman E6
[3]	Crown PZM 30D
[2]	Crown GLM100
[8]	Crown PCC160
[4]	DPA V04099B w/ assorted clips
[1]	Earthworks FM500/HC
[2]	EV 635A
[1]	EV N/D868
[4]	EV N/D468
[1]	EV RE20
[4]	Neumann KM 184
[3]	Sennheiser 421
[2]	Sennheiser e609
[1]	Sennheiser MD 431
[3]	Sennheiser e604
[1]	Neumann KMX105



## **Direct Boxes**

- [2] Radial JDI
- [2] Radial Pro D2
- [4] Radial Pro D1
- [2] Radial ProAV2
- [2] Radial J48
- [3] Countryman Type 85
- [2] Whirlwind HotBox
- [1] Horizon Speakerline DI
- [1] Whirlwind 4-Channel DI
- [2] MS-3 Mic Splitter
- [1] Artcessories Com Splitter

## **Portable Consoles**

- [1] Behringer X32 console
- [1] Behringer X32 rack
- [1] Mackie 1202-VLZ
- [1] Behringer xAir12

## **Portable Speakers\***

- [2] EV ETX-15P
- [2] EV ETX-18SP
- [2] EV S-1803ER
- [2] QSC K12
- [5] EAW-JF60Z

## **Foldback Speakers\***

- [10] Crown 6002 XTI Series Amplifiers
- [8] JBL VRX915M 15in 2-way floor monitors
- [2] Radian Apex 1500
- [4] Radian Apex 1200
- [2] Radian Micro RMW-1122

## **Cable**

- [1] 100' 16x4-channel XLR3 stage box
- [1] 100' 12x3-channel XLR3 stage box
- [1] 50' 12-channel XLR3 stage box
- [2] 10' 8-channel XLR3 drive snake

Approximately 3000' miscellaneous lengths of microphone cable.

Approximately 1000' miscellaneous lengths of speaker cable with NL4 connectors.

\*The house owns any necessary power amps for all passive speakers listed above

## **Appendix B – Supplemental Video Inventory**

Baum Walker Hall needs take precedent for use of this equipment.

All equipment availability and use subject to advance.

### **Projectors**

- [2] Christie Roadster WU12K-M projectors

### **Projector Lenses**

- [2] Christie ILS Lens 1.5-2.0SX+/1.4-1.8HD
- [2] Christie ILS Lens 4.5-7.1SX+/4.1-6.9HD

### **Projection Screens**

- [2] Da-Lite 99814 Heavy Duty Fast-Fold Deluxe Projection Screen  
(8'7" x 14'5" / 262 x 439 cm)  
(Screens are flown, not ground supported)

### **Video Switchers**

- [1] Analog Way NeXtage 16 (LiveCore) - NXT1604 (1080p model)
- [2] Blackmagic Design ATEM Television Studio HD

### **Signal Conversion**

- [2] Decimator MD-HX HDMI / SDI Cross Converter
- [2] Decimator MD-CROSS V2 HDMI / SDI Cross Converter (overlays/test pattern)
- [2] Decimator MD-LX HDMI / SDI Bi-Directional Converter
- [2] Monoprice Blackbird 4K HDMI Audio Extractor
- [1] Monoprice Blackbird 4K HDMI Audio Inserter

### **Content Sources**

- [2] Apple MacBook Pro 16 (touch bar model)
  - [2] Brydge Stone Pro Thunderbolt 3 Docks
  - [2] USB-C to HDMI adapter cables
  - [2] DisplayPort to HDMI adapter cables
  - [2] Qlab 4 AVL licenses
- [2] Dell Latitude 5580 laptops (Windows 10)
- [3] Mini PC Stick 8GB RAM 128GB ROM with Intel Atom Z8350 & Windows 10 Pro

### **Video Cable**

An assortment of 3G SDI cable is available, along with a variety of other cables and adapters for general video needs.

## **Displays**

- [2] Samsung 65-Inch BE65T-H Pro 4K Commercial Displays
- [4] Samsung 55-Inch BE55T-H Pro 4K Commercial Displays

## **Display Stands**

- [6] Premier Mounts Low-Profile Dual Pole Floor Stand Base
- [2] Premier Mounts Lightweight Dual Pole Floor Stand Base
- [2] Premier Mounts 84” Chrome Poles (pair)
- [2] Premier Mounts 72” Chrome Poles (pair)
- [6] Premier Mounts 60” Chrome Poles (pair)
- [4] Premier Mounts Universal Low-Profile Flat Panel Mount for Dual Pole Stands (pair)
- [1] Premier Mounts Shelf for Dual Pole Stands

## **Appendix C – Instrument Inventory**

Baum Walker Hall needs take precedent for use of this equipment.  
All equipment availability and use subject to advance.

### **Drums**

- [1] 21"/53cm Zildjian Avedis Sweet Ride
- [1] 18"/45cm Zildjian Avedis Medium Thin Crash
- [1] 16"/40cm Zildjian Avedis Medium Thin Crash
- [1] 14"/36cm Zildjian Avedis New Beat Hi-hat Top
- [1] 14"/36cm Zildjian Avedis New Beat Hi-hat Bottom
- [1] 22" Yamaha Absolute Bass Drum with Ahead Armor Case
- [1] 18" Yamaha Absolute Bass Drum with Ahead Armor Case
- [1] 16" Yamaha Absolute Floor Tom with Ahead Armor Case
- [1] 14" Yamaha Absolute Floor Tom with Ahead Armor Case
- [1] 12" Yamaha Absolute Tom with Ahead Armor Case
- [1] 10" Yamaha Absolute Tom with Ahead Armor Case
- [1] 14" Yamaha Absolute Snare with Ahead Armor Case
- [1] Yamaha Hi-hat Stand
- [1] DW5000 Kick Pedal
- [1] Yamaha Kick Pedal
- [1] Yamaha Tom Mount for two toms
- [1] Yamaha Snare Drum Stand
- [2] Pearl Snare Drum Stand
- [1] DW5000 Drum Throne
- [2] Pearl Cymbal Boom Stand
- [3] Yamaha Cymbal Boom Stand
- [1] Gibraltar Cymbal Boom Stand
- [3] Yamaha Cymbal Stand
- [1] Five Segment Drum Shield
- [2] 4' x 3' Drum Rug

### **Percussion**

- [1] Adams Alpha Vibraphone
- [1] Zildjian "C to C" Crotales
- [1] Pearl Cajon
- [1] LP Udu Drum Utar
- [1] Meinl Guiro
- [1] Finger Cymbals
- [1] Treeworks Chimes
- [1] Duplex Sleigh Bells
- [1] Woodblock
- [1] Maracas

## **Piano/Keys**

- [2] Steinway & Sons Grand Piano
- [1] Upright practice Piano
- [1] M-Audio Hammer 88 Keyboard
- [1] Kawai ES110 Digital Piano with Case
- [1] Kawai F-10H Sustain Pedal
- [1] Alesis ASP-2 Sustain Pedal
- [1] M-Audio EX-P Expression Pedal
- [1] ProLine Double Keyboard Stand
- [1] ProLine Keyboard Stand
- [2] OnStage Keyboard Stand
- [2] ProLine Keyboard Bench
- [1] OnStage Keyboard Bench

## **Strings**

- [1] Aquilar DB751 750-Watt hybrid bass head
- [1] Aguilar DB410 700-Watt bass cabinet
- [1] Fender '65 Deluxe Reverb 22-Watt 1x12 combo amp

## **Miscellaneous**

- [1] Hercules Three Guitar Stand
- [1] Hercules Guitar Stand
- [6] OnStage Guitar Stand
- [1] Full Size French Bass Bow

## **Appendix D – Ground Plans & Layouts**

### **Walton Arts Center Facility – Floor Plan – Level 1**

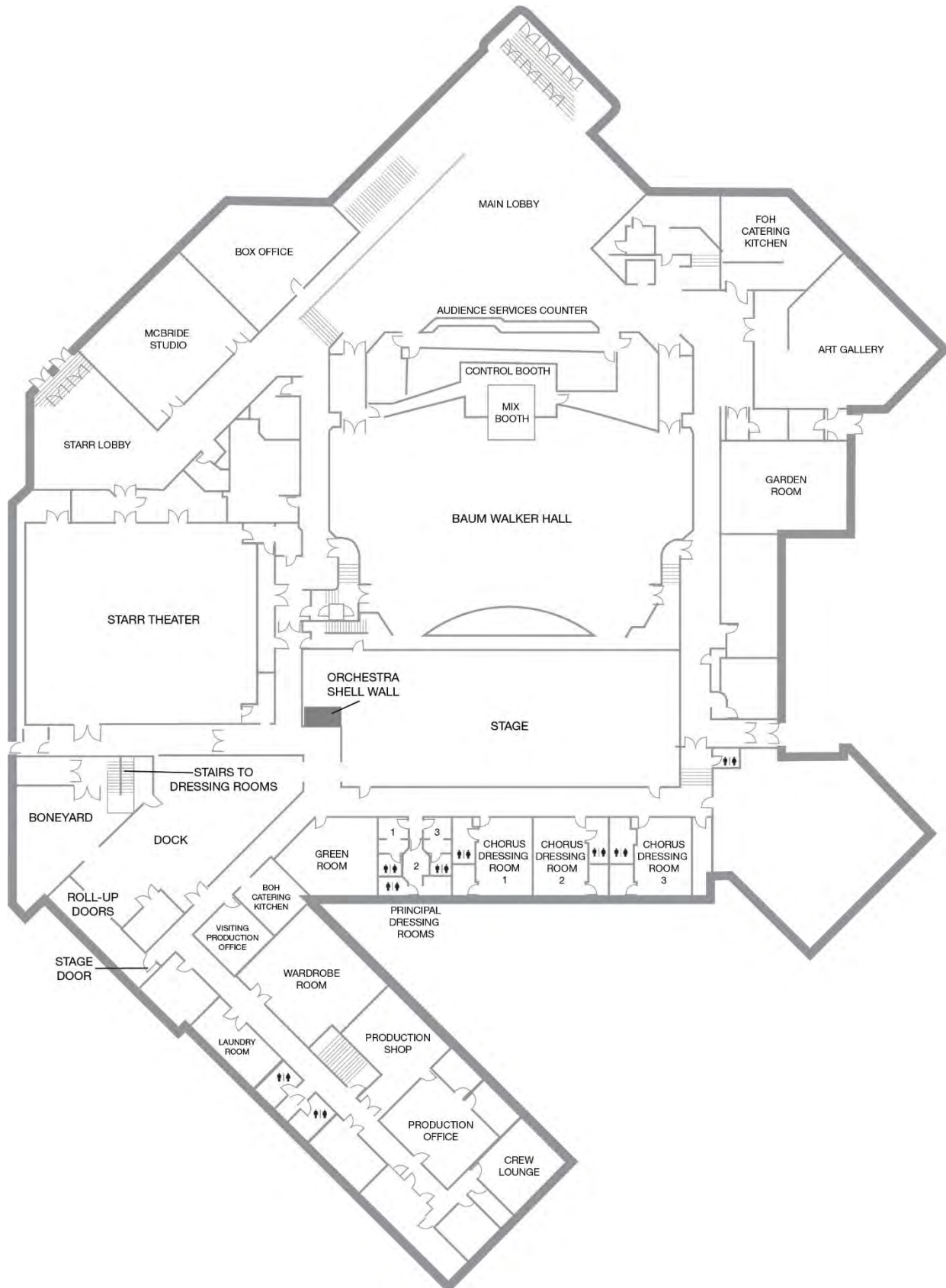

Walton Arts Center Facility – Floor Plan – Level 2

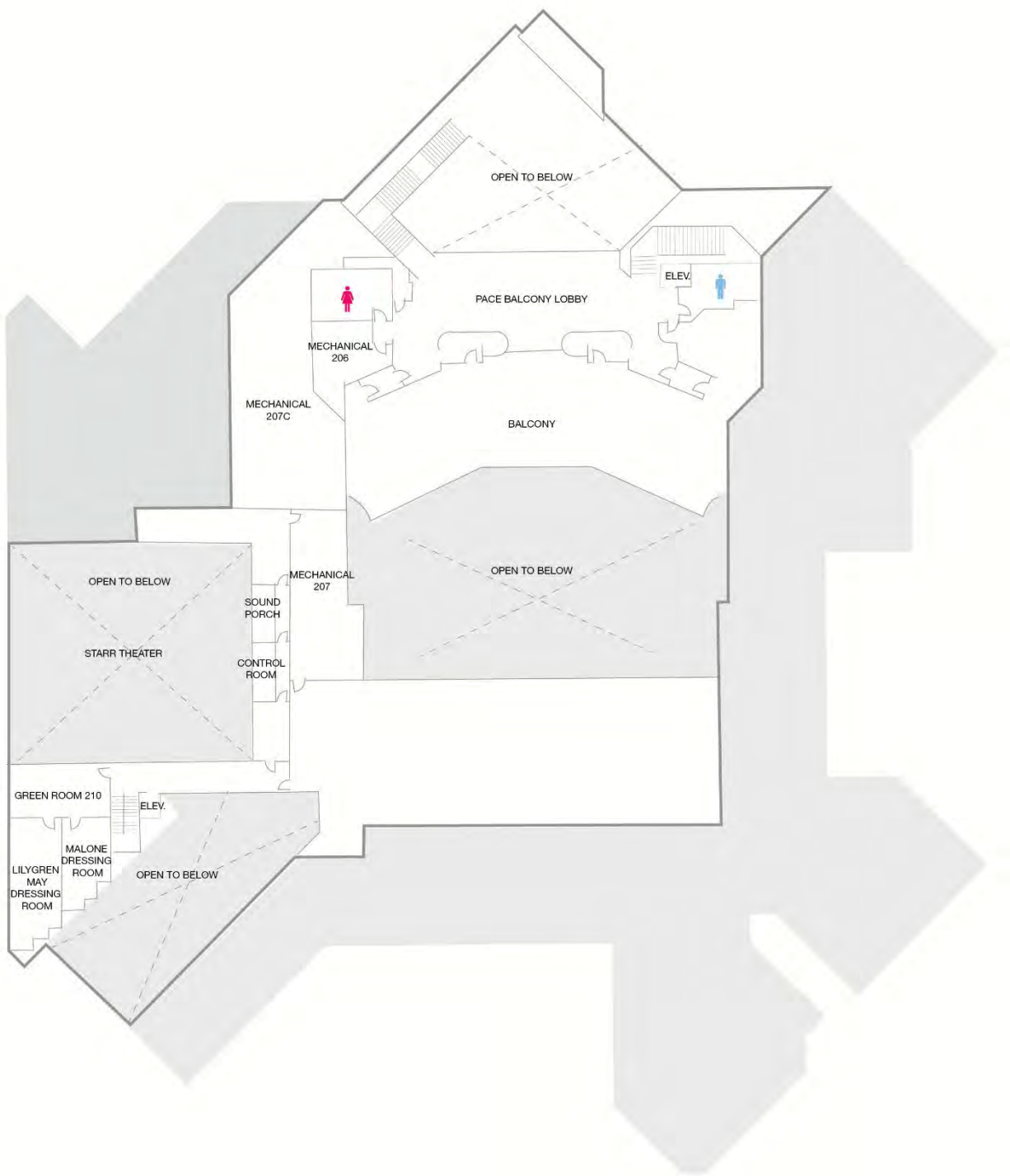



## Starr Theater – Empty Layout

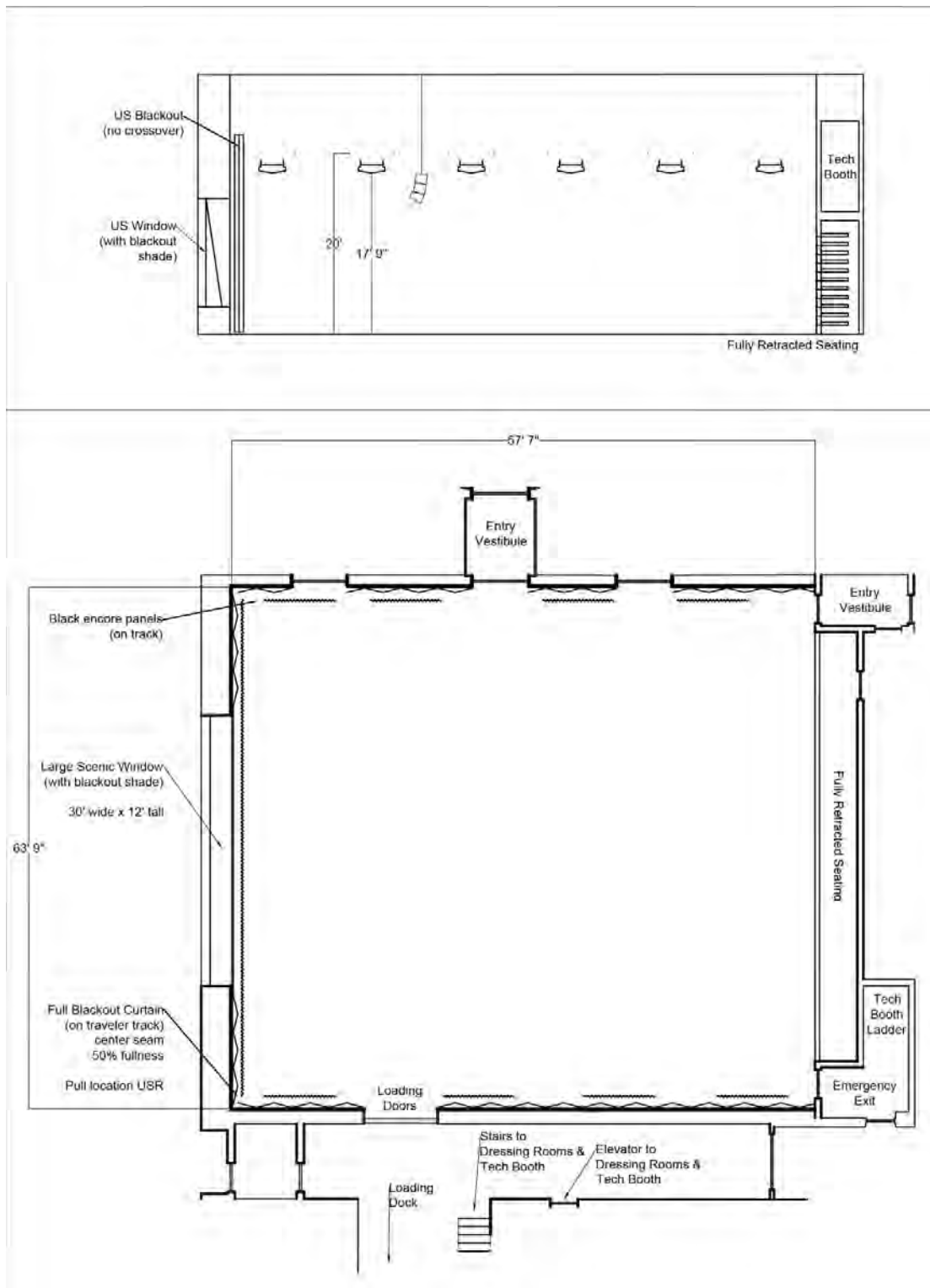

## **Starr Theater – Catwalk Layout**

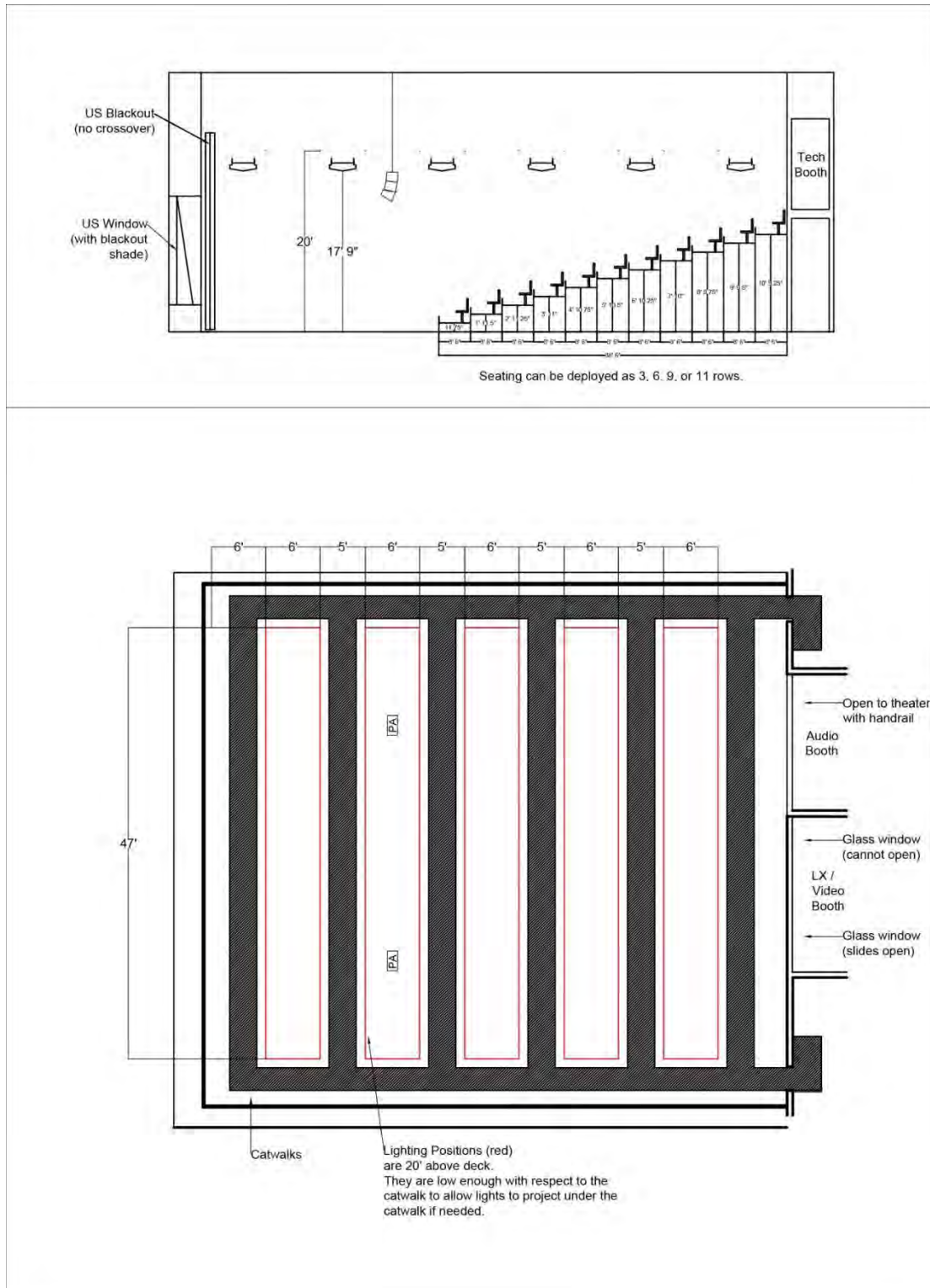

US Blackout  
(no crossover)

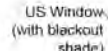

20

17.9°

†

+

--	--

1

10

Seating can be deployed as 3, 6, 9, or 11 rows.

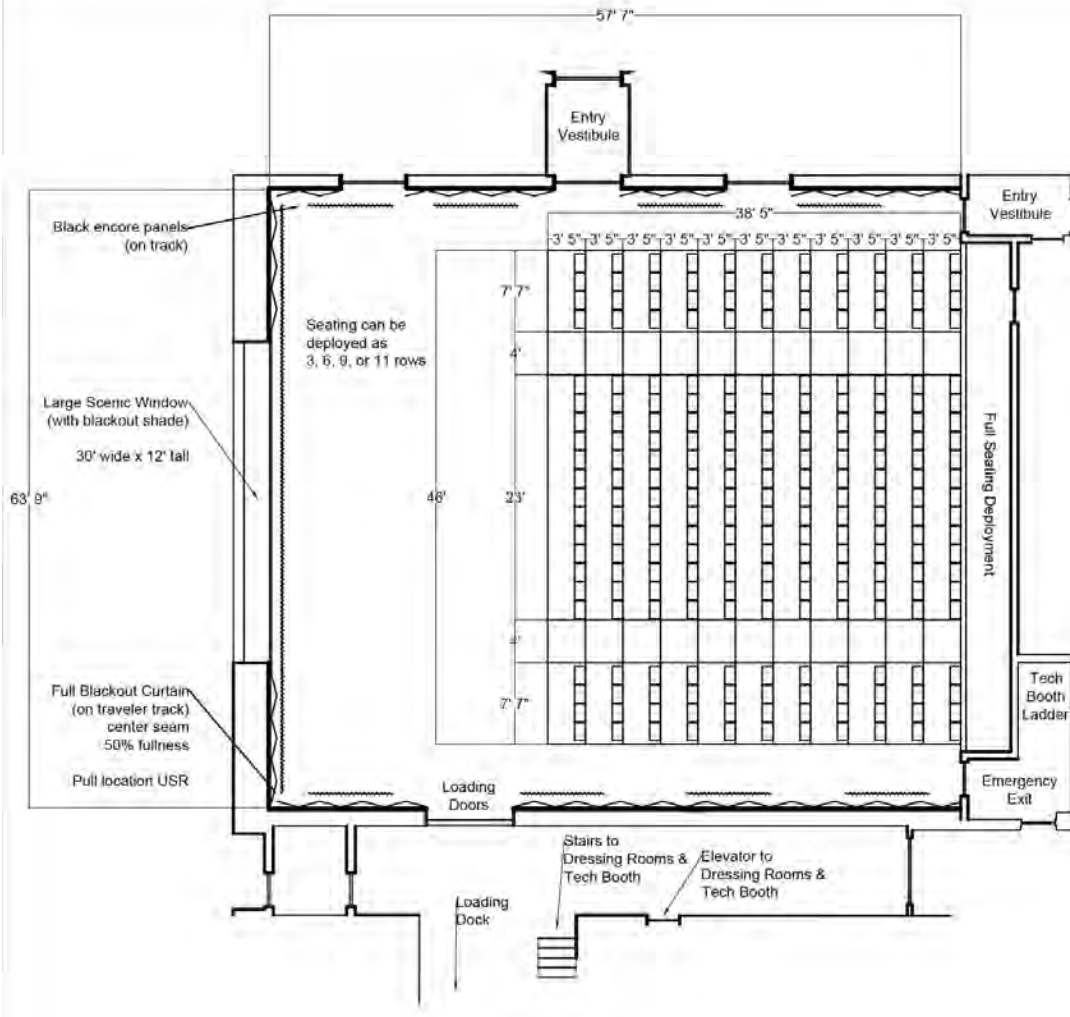

## **Appendix E - Photos**

### **Venue Truck Entrance**



### **Venue Loading Dock**





### **Starr Theater – Stage Area**



### **Starr Theater – Fully Deployed Seating**



### **Starr Theater – Fully Retracted Seating**



### **Starr Theater – Green Room**





### **Starr Theater – Large Dressing Room**



### **Starr Theater – Small Dressing Room**





### Interior Loading Dock View



### Stage View from Loading Dock

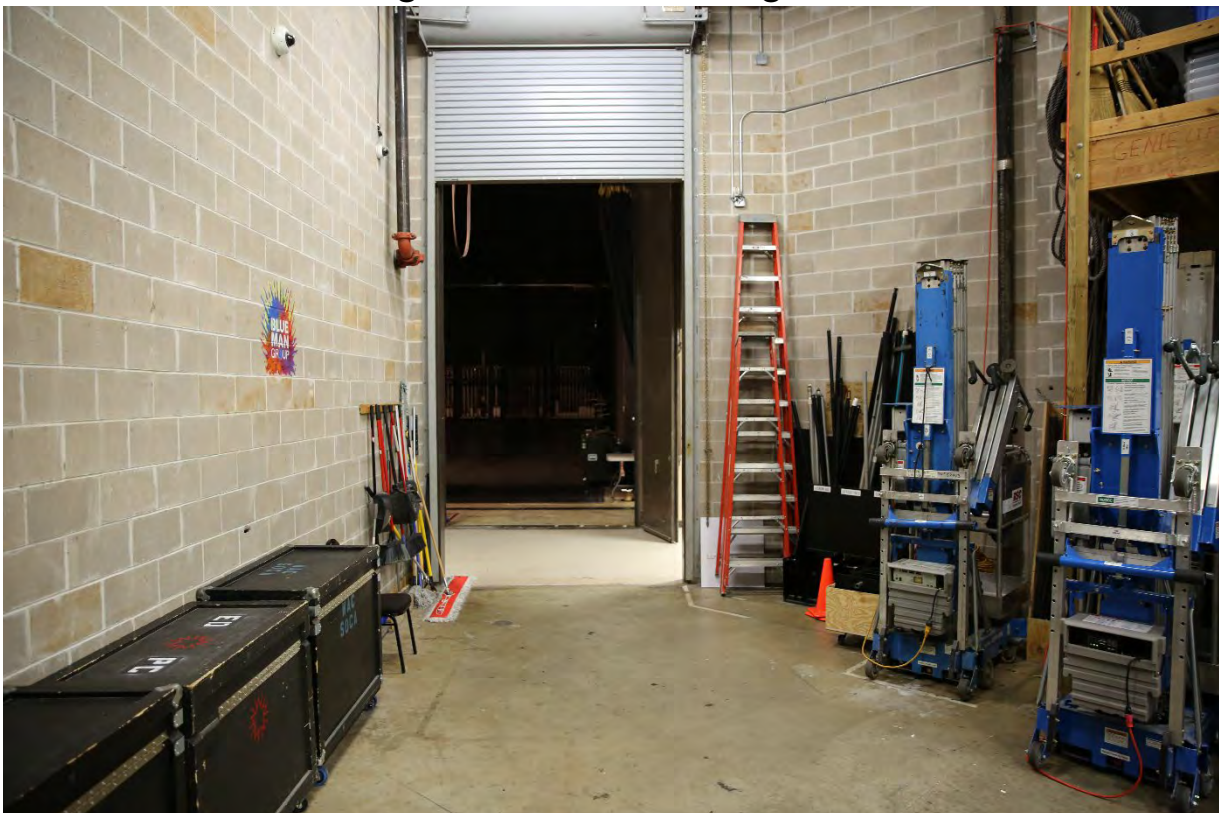



### **Additional Storage – “Boneyard”**



### **“Boneyard” – Alternate View**



### Wardrobe Room



### Laundry Room



**Visiting Production Office**

