



Walton Arts Center

Technical Package



Starr Theater

Revision 16.3.1 – August 10, 2024



Walton Arts Center

Starr Theater

Technical Information Package

<u>Administrative Offices (shipping):</u>	255 N School Ave, Fayetteville, AR 72701
<u>Stage Door/Loading Dock (freight):</u>	495 W Dickson St, Fayetteville, AR 72701
<u>Billing:</u>	PO Box 3547, Fayetteville, AR 72702-3547
<u>Main Phone:</u>	479-443-9216
<u>Box Office Phone:</u>	479-443-5600
<u>Website:</u>	waltonartscenter.org

For ALL incoming USPS/UPS/FedEx packages, please use Administrative Offices. All packages will be signed for by the front desk receptionist, logged, and delivered to stage level by venue staff.

Packages are not delivered by carriers on Saturday or Sunday, so please arrange shipments accordingly.

Please notify production staff of any outgoing packages and use the Administrative Offices as the pickup address.

All freight must use the Loading Dock address.

Contents

Contact Information.....	6
Director, Programming	6
General Manager	6
Production Staff	6
Technical Director	6
Assistant Technical Director	6
Artist Services Coordinator.....	6
Production Manager	6
Audio Supervisor	6
Senior Production Coordinator	6
Front of House	6
Box Office	6
Box Office Manager.....	6
Driving Directions	7
Company Management.....	8
Green Room and Dressing Rooms (see “Appendix E - Photos” – page 25).....	8
Production Office.....	8
Stage Manager’s Console	8
Local Crew	8
Access for People with Disabilities	8
Policies	8
Labor Rates & Crew Policies.....	9
Carpentry	10
Loading Dock (see “Appendix E - Photos” – page 25)	10
Stage Dimensions	10
Stage Floor.....	10
Soft Goods	10
Seating Capacity	10
Props	11
Music.....	11
Platforms/Riser Decks.....	11
Lectern	11

Dance Floor.....	11
Electrics	12
Instrument Inventory.....	12
Control Console.....	12
House Lights (controlled via DMX universe 1).....	12
Dimmers (controlled via DMX universe 1)	12
Company Switch	12
Cabling	12
Miscellaneous.....	12
Circuit and Dimmer Schedule.....	12
Audio.....	13
Control Location	13
Production Communications.....	13
Mixing Console.....	13
Fixed Speakers	13
Power Amps	13
Wireless Mics	13
Wardrobe	14
Wardrobe Area (see “Appendix E - Photos” – page 31).....	14
Laundry Room (see “Appendix E - Photos” – page 31).....	14
Appendix A – Supplemental Audio Inventory	15
Mics.....	15
Direct Boxes	16
Portable Consoles	16
Portable Speakers*	16
Foldback Speakers*	16
Cable.....	16
Appendix B – Supplemental Video Inventory	17
Projectors	17
Projector Lenses	17
Projection Screens	17
Video Switchers.....	17
Signal Conversion	17
Content Sources.....	17

Video Cable.....	17
Displays.....	18
Display Stands	18
Appendix C – Instrument Inventory.....	19
Drums.....	19
Percussion.....	19
Piano/Keys	19
Miscellaneous.....	20
Appendix D – Ground Plans & Layouts.....	21
Walton Arts Center Facility – Floor Plan – Level 1	21
Walton Arts Center Facility – Floor Plan – Level 2	22
Starr Theater – Empty Layout	23
Starr Theater – Catwalk Layout.....	24
Starr Theater – Seating Layout	25
Appendix E - Photos	26
Venue Truck Entrance.....	26
Venue Loading Dock	26
Starr Theater – Stage Area	27
Starr Theater – Fully Deployed Seating.....	27
Starr Theater – Fully Retracted Seating	28
Starr Theater – Green Room.....	28
Starr Theater – Large Dressing Room.....	29
Starr Theater – Small Dressing Room.....	29
Interior Loading Dock View.....	30
Stage View from Loading Dock	30
Additional Storage – “Boneyard”	31
“Boneyard” – Alternate View.....	31
Wardrobe Room	32
Laundry Room.....	32
Visiting Production Office	33

Contact Information

Director, Programming

Jennifer Ross
Office: 479-571-2778
[jross@waltonartscenter.org](mailto:ross@waltonartscenter.org)

General Manager

Bob Pless
Office: 479-571-2791
bpless@waltonartscenter.org

Production Staff

Technical Director

Alex Newby
Office: 479-571-2736
anewby@waltonartscenter.org

Production Manager

Cody Kopp
Office: 479-571-2701
ckopp@waltonartscenter.org

Assistant Technical Director

Josh Spurgers
Office: 479-571-2713
jspurgers@waltonartscenter.org

Audio Supervisor

Honnah Sartin
Office: 479-571-2729
hsartin@waltonartscenter.org

Artist Services Coordinator

Kayli Patterson
Office: 479-316-7544
kpatterson@waltonartscenter.org

Senior Production Coordinator

Hali Pinson
Office: 479-571-2711
hpinson@waltonartscenter.org

Front of House

Patron Services Manager

Ranny Kulink
Office: 479-571-2754
rkulink@waltonartscenter.org

Box Office

Box Office Manager

Andrew Crowe
Office: 479-571-2750
acrowe@waltonartscenter.org

For local hospitality and lodging information, please contact the **Artist Services Coordinator**.

Fayetteville, Arkansas is located in the Northwest corner of Arkansas in the **Central Time Zone**.

Driving Directions

Walton Arts Center – Fayetteville, Arkansas - 479-443-9216

- **From the South:** From I-40 take I-49 North at Alma, Arkansas.
- **From the North:** From I-44 take US-71 South at Joplin, Missouri (it will turn into I-49 in Bentonville, Arkansas).
- **From the West:** From I-44 take US-412 East at Tulsa, Oklahoma. Turn South at I-49 in Springdale, Arkansas.
- **From the East:** The two options are I-40 and I-44; see above.

Once on **I-49**, take **EXIT 62** which is also US-62.

Turn East and continue **1.8 miles** to a traffic light at the intersection with **School Avenue** (O'Reilly Auto Parts and Walgreen's at the intersection).

Turn left on School Avenue. Go **0.9 mile** on a curved, 4-lane uphill through a double "S", continuing to the intersection with **Dickson Street** (Washington County Courthouse on your right).

Turn left on Dickson Street. Go downhill **0.4 mile** to the traffic light at the intersection with **West Avenue** and **turn left**. The WAC is on the corner to your left. The **first driveway on your left** will line you up to back into our loading dock.

Ample public parking is available across the street to the West of the theater. Arrangements can be made for onsite or offsite bus, truck, and trailer parking based on the needs of the production.

Please forward these directions to your transportation captain or lead driver.

Company Management

Green Room and Dressing Rooms (see “Appendix E - Photos” – page 26)

The green room and dressing rooms are located upstairs, accessible from the USR loading doors and via elevator. There are 2 dressing rooms, each with shower and restroom facilities. One dressing room has 10 stations and the other has 5 stations.

Production Office

The production office is a dedicated touring production office, located just inside the stage door. Availability is contingent on use from the main hall (Baum Walker Hall). If the main hall is empty or the resident company does not require it, it will be made available to companies residing in Starr Theater.

Stage Manager’s Console

The stage managers console is typically located in the SR hallway, and includes both wired and wireless Clear-Com, a video monitor, and paging to all theater spaces. It can be located onstage or in the tech booth, if preferred.

Local Crew

The Director of Production and department heads are full-time Walton Arts Center staff. Local stagehands are non-union and are employed by Walton Arts Center on an as-needed basis. All crew sizes, skills, and specialties are available on request and per contract negotiations with advanced notice. Most local crew members are cross-trained and can switch departments as required.

Access for People with Disabilities

All backstage areas are accessible to people with disabilities. All spaces are on the same level except for the orchestra pit, which is equipped with a stair lift. All front-of-house and patron areas are ADA compliant.

Policies

- House opens at one half hour before curtain.
- Walton Arts Center does not provide alcohol for staff, cast, or crew. However, companies may bring their own alcohol.
- The entire building is non-smoking, including the exterior loading dock and an 85’ radius from every entrance. The smoking area is located outside the loading dock.
- Badges/laminates are to be worn at all times.
- The building curfew is 11:00 PM on weekdays and 12:00 PM on weekends. This is subject to change based on the needs of the show.
- The stage door can be accessed beginning at 8:00 AM. This is subject to change based on the needs of the show.
- Walton Arts Center reserves the right to restrict operation of house equipment to Walton Arts Center personnel. Walton Arts Center reserves the right of final approval on all rigging, pyrotechnic, and/or safety issues.
- Hard hats require while riggers working overhead.
- Maximum allowable level is 95 dBA average measured at mix position.

Labor Rates & Crew Policies

Rates

- Stagehands: \$32/hr
- Up Rigger: \$57/hr
- Down Rigger: \$52/hr

OT Rules

- **1.5x** after 40 hours worked on the week.
- **1.5x** for hours worked between midnight-5:59 a.m., or on an observed holiday.
- **2x** for hours worked over 40 hours during midnight time or on an observed holiday.
- **3x** for hours worked over 40 hours during midnight time **and** on an observed holiday.

Labor Policies:

- All calls are subject to 4-hour minimum calls. If two shifts are scheduled more than 8 hours apart (meaning there is 8 hours between the end of a shift and the beginning of a new one), each shift is subject to a new 4-hour minimum.
- All crew that work more than 5 consecutive hours in a shift must be given a 1-hour walkaway break. If a break of that duration cannot be provided, then a catered 30-minute break on the clock must be provided. If a catered meal cannot be provided, then a meal penalty of 1 hour at 2x the stagehand rate will be charged for all crew affected.
- When rigging is needed, a minimum of 3 riggers (2 up, 1 down) is required.
- Fly-rail operators will be charged the down rigging rates while rigging work is being done.
- Departments can cross over into other areas.
- Cancellations must be at least 24 hours in advance. Cancellations less than 24 hours of a scheduled call will result in a 4-hour minimum call being charged for each cancelled crew member.
- Labor requests less than a week in advance are subject to availability.
- Walton Arts Center Production has final authority on all matters pertaining to the Local Stagehand Crew.

Any questions regarding labor or billing rates can be directed to Production Manager.

Carpentry

Loading Dock (see “Appendix E - Photos” – page 26)

Loading dock can hold 2 tractor/trailers.

Dock exterior walking surface is 35' x 10' and covered.

Truck height is 4' 0" high by 23' wide.

Bobtail dock is 1' 10" high by 11' 9" wide.

[2] loading doors, each 10' 7" high by 7' 9" wide

[2] 50A, 120'208V, 1Ø receptacles (NEMA B-33) available for shore power

Distance from dock to theater is approximately 50' at stage level.

Stage Dimensions

Bare space is 57' 7" wide by 63' 9" deep.

Retractable stadium seating permanently installed in north wall.

The seating system can be deployed as 3 rows, 6 rows, 9 rows, or all 11 rows.

Each row is approximately 3' 6" deep and contains 21 chairs.

The south wall has a large picture window with blackout curtain.

The window is 30' wide by 12' high.

The catwalk height is 19'.

The loading door opening is 12' tall by 7' wide.

Stage Floor

Sprung surface, black semi-gloss painted Masonite surface. No traps. Deck screws only.

Soft Goods

[2] Tabs (black Encore) - 24' wide, sewn flat.

[4] Legs (black Encore) – 12' wide, sewn flat.

[1] Star Drop (black Encore, white 8ch LED) – 48' wide, sewn flat.

[1] Cyclorama (white Leno) – 48' wide, seamless.

All soft goods are 20' tall.

Room is equipped with SL and SR traveler track with 16' tall black Encore panels sewn 50% full. There is also an upstage traveler track against the south wall covering the picture window.

Additional soft goods are available as required.

Seating Capacity

[231] Collapsible Bleachers (Chairs and/or cocktail tables as required)

The maximum occupancy of the room is 250. However, this is for a combination of bleacher and cabaret-style seating typically used for small ensemble concerts. Due to the highly flexible nature of Starr Theater, a wide variety of seating configurations are possible, each with its own regulatory limitations. Actual capacities can be determined on an individual basis based on the production's needs and are subject to approval by Walton Arts Center management and the Fayetteville Fire Marshall.

Props

Music

- [100] Wenger orchestra chairs (black, assorted heights)
- [67] Wenger music stands (black)
- [61] Music stand lights (incandescent, dimmable upon request)
- [1] Wenger conductor's music stand
- [1] Wenger conductor's podium (two-levels at 6" and 12" heights)

Platforms/Riser Decks

- [24] Wenger Versalite decks (4' by 8')
- [144] Adjustable legs (18"-40" height range)
 - Fixed legs also available in 8" increments.
 - Additional risers and legs available when required
 - Velcro skirts available at 8", 16", and 24". (approximately 120 running feet each)

Lectern

- [1] WAC branded lectern (birch and silver, 2' wide by 4' high)

Dance Floor

Harlequin reversible dance floor (black/white, semi-gloss, rolls 6'6" wide)

- [5] 65' long rolls
- [1] 58' long roll
- [5] 41' long rolls

Electrics

Instrument Inventory

- [50] Source Four Junior Zooms
- [25] Source Four PAR (VNSP, NSP, MFL, and WFL lenses in stock)
- [25] Source Four PARnel
- [8] Fixed LED curtain warmers (along east/west walls)

Control Console

- [1] ETC IonXE20 with two touchscreen monitors.

House Lights (controlled via DMX universe 1)

Digital control from FOH lighting booth, with optional control from HL or audio position.

Dimmers (controlled via DMX universe 1)

- [96] 2.4 kW ETC Sensor D20AF modules

Company Switch

120/208V; 3Ø; 200A; company switch located just outside SR loading door.

Cabling

- [15] 5' 12/3 2P&G/stage pin
- [15] 10' 12/3 2P&G/stage pin
- [15] 25' 12/3 2P&G/stage pin

Miscellaneous

- [1] Genie AWP-36 personnel lift – 36' lift

Circuit and Dimmer Schedule

Outlet Location	2.4 kW / 20 A Dimmers	2.4 kW / 20 A Relays
Catwalk 1 (booth)	1-18	200-202
Catwalk 2	19-42	203-208
Catwalk 3	43-66	209-214
Catwalk 4	67-90	215-220
Catwalk 5	91-120	221-227
Catwalk 6 (window)	121-144	228-235
HL wall	145-148	236
DSR wall	149-154	237
USR wall	155-160	238-239
HR wall	161-164	240
DSL wall	165-170	241
USL wall	171-176	242-243
Lighting Booth	177-178	244-245

**ALL DIMMER CONNECTORS ARE 20 AMP 2P&G / STAGE PIN
ALL RELAY CONNECTORS ARE 20 AMP EDISON / NEMA 5-20R**

Audio

Control Location

18' 8" wide by 8' 3" deep mezzanine-level booth in rear of house (6' off-center right)

Production Communications

- [1] Clear-Com MS-702 2-channel main station
- [4] RS 701 2-channel belt packs
- [1] Clear-Com F1-1 call flasher
- [1] Clear-Com handset phone
- [1] HME DX210 wireless base station
- [4] HME BP200 wireless belt packs

Mixing Console

Yamaha CL1-1 console with Yamaha Rio 3224-D (32in/16out XLR stage box)

Fixed Speakers

- [4] Nexo GEOS 1210 full range speakers
- [2] Nexo GEOS 1230 full range down-fill speakers
- [2] Nexo LS18 subwoofer

Power Amps

- [1] Nexo NXAMP 4x4

Wireless Mics

- [1] Shure ULXD4D 2-channel wireless receiver
- [2] Shure ULXD2 handheld transmitters w/ Shure Beta87a capsules
- [1] Shure ULXD1 body pack transmitter

Starr Theater is equipped with almost limitless liquidity to patch audio, SDI video signal, and CAT6 networking throughout the entire room.

The equipment listed above is assigned to Starr Theater. Additional resources may be available. Please see Appendix A (page 15) for a list of other inventory.

Maximum sound levels are closely monitored.

Walton Arts Center will have final approval on all levels.

Wardrobe

Wardrobe Area (see “Appendix E - Photos” – page 32)

967 square foot wardrobe room located just inside stage door.

- [10] 20A electrical circuits (NEMA 5-20R)
- [10] rolling racks
- [5] steamers
- [5] irons
- [5] ironing boards
- [2] sinks with spray wands
- [1] sewing table and heavy duty machine

This room does not have direct access to outside ventilation. This room is approximately 150' from the dressing room hallway and SL entrance.

The main hall (Baum Walker Hall) takes precedent for wardrobe room usage when both venues are in use.

Quick change booths are available. (pipe and drape or flats)

Laundry Room (see “Appendix E - Photos” – page 32)

200 square foot laundry facility

- [2] standard capacity washers (Samsung MODEL NO. WF36J4000AW/A2)
 - [2] standard capacity dryers (Samsung MODEL NO. DV36J4000EW/A3)
 - [1] high capacity washer (Samsung MODEL NO. WF56H9100AW/A2)
 - [1] high capacity dryer (Samsung MODEL NO. DV56H9100EW/A2)
- Electrical and water for additional W/D hookup in room.*
- [2] deep basin utility sinks
 - [2] 6' tables of sorting space

The main hall (Baum Walker Hall) takes precedent for laundry room usage when both venues are in use, however at least 1 washer and 1 dryer will be made available.

Appendix A – Supplemental Audio Inventory

Baum Walker Hall needs take precedent for use of this equipment.

All equipment availability and use subject to advance.

Mics

- [14] Shure SM58
- [9] Shure SM57
- [1] Shure SM81
- [1] Shure Beta 52A
- [1] Shure Beta 57A
- [1] Shure Beta 91
- [3] Shure Beta 98
- [4] Shure Beta 87A wireless
- [2] Shure SM58 wireless
- [2] Shure MX405 w/ pre-amp MX400DP
- [1] Shure WL93
- [1] Shure WL184
- [1] Shure WL185
- [2] Shure KSM 32
- [2] AKG C414B
- [5] AudioTechnica AT Pro 45
- [2] AudioTechnica AT835
- [2] AudioTechnica AT 4050
- [4] AudioTechnica AT4041
- [1] Beyerdynamic M88TG
- [4] Countryman E6
- [3] Crown PZM 30D
- [2] Crown GLM100
- [8] Crown PCC160
- [4] DPA V04099B w/ assorted clips
- [1] Earthworks FM500/HC
- [2] EV 635A
- [1] EV N/D868
- [4] EV N/D468
- [1] EV RE20
- [4] Neumann KM 184
- [3] Sennheiser 421
- [2] Sennheiser e609
- [1] Sennheiser MD 431

Direct Boxes

- [2] Radial JDI
- [2] Radial Pro D2
- [4] Radial Pro D1
- [2] Radial ProAV2
- [2] Radial J48
- [3] Countryman Type 85
- [2] Whirlwind HotBox
- [1] Horizon Speakerline DI
- [1] Whirlwind 4-Channel DI
- [2] MS-3 Mic Splitter
- [1] Artcessories Com Splitter

Portable Consoles

- [1] Behringer X32 console
- [1] Behringer X32 rack
- [1] Mackie 1202-VLZ
- [1] Behringer xAir12

Portable Speakers*

- [2] EV ETX-15P
- [2] EV ETX-18SP
- [2] EV S-1803ER
- [2] QSC K12
- [5] EAW-JF60Z

Foldback Speakers*

- [10] Crown 6002 XTI Series Amplifiers
- [2] Radian Apex 1500
- [4] Radian Apex 1200
- [2] Radian Micro RMW-1122

Cable

- [1] 100' 16x4-channel XLR3 stage box
- [1] 100' 12x3-channel XLR3 stage box
- [1] 50' 12-channel XLR3 stage box
- [2] 10' 8-channel XLR3 drive snake

Approximately 3000' miscellaneous lengths of microphone cable.

Approximately 1000' miscellaneous lengths of speaker cable with NL4 connectors.

*The house owns any necessary power amps for all passive speakers listed above

Appendix B – Supplemental Video Inventory

Baum Walker Hall needs take precedent for use of this equipment.
All equipment availability and use subject to advance.

Projectors

- [2] Christie Roadster WU12K-M projectors

Projector Lenses

- [2] Christie ILS Lens 1.5-2.0SX+/1.4-1.8HD
- [2] Christie ILS Lens 4.5-7.1SX+/4.1-6.9HD

Projection Screens

- [2] Da-Lite 99814 Heavy Duty Fast-Fold Deluxe Projection Screen
(8'7" x 14'5" / 262 x 439 cm)
(Screens are flown, not ground supported)

Video Switchers

- [1] Analog Way NeXtage 16 (LiveCore) - NXT1604 (1080p model)
- [2] Blackmagic Design ATEM Television Studio HD

Signal Conversion

- [2] Decimator MD-HX HDMI / SDI Cross Converter
- [2] Decimator MD-CROSS V2 HDMI / SDI Cross Converter (overlays/test pattern)
- [2] Decimator MD-LX HDMI / SDI Bi-Directional Converter
- [2] Monoprice Blackbird 4K HDMI Audio Extractor
- [1] Monoprice Blackbird 4K HDMI Audio Inserter

Content Sources

- [2] Apple MacBook Pro 16 (touch bar model)
 - [2] Brydge Stone Pro Thunderbolt 3 Docks
 - [2] USB-C to HDMI adapter cables
 - [2] DisplayPort to HDMI adapter cables
 - [2] Qlab 4 AVL licenses
- [2] Dell Latitude 5580 laptops (Windows 10)
- [3] Mini PC Stick 8GB RAM 128GB ROM with Intel Atom Z8350 & Windows 10 Pro

Video Cable

An assortment of 3G SDI cable is available, along with a variety of other cables and adapters for general video needs.

Displays

- [2] Samsung 65-Inch BE65T-H Pro 4K Commercial Displays
- [4] Samsung 55-Inch BE55T-H Pro 4K Commercial Displays

Display Stands

- [6] Premier Mounts Low-Profile Dual Pole Floor Stand Base
- [2] Premier Mounts Lightweight Dual Pole Floor Stand Base
- [2] Premier Mounts 84" Chrome Poles (pair)
- [2] Premier Mounts 72" Chrome Poles (pair)
- [6] Premier Mounts 60" Chrome Poles (pair)
- [4] Premier Mounts Universal Low-Profile Flat Panel Mount for Dual Pole Stands (pair)
- [1] Premier Mounts Shelf for Dual Pole Stands

Appendix C – Instrument Inventory

Baum Walker Hall needs take precedent for use of this equipment.
All equipment availability and use subject to advance.

Drums

- [1] 21"/53cm Zildjian Avedis Sweet Ride
- [1] 18"/45cm Zildjian Avedis Medium Thin Crash
- [1] 16"/40cm Zildjian Avedis Medium Thin Crash
- [1] 14"/36cm Zildjian Avedis New Beat Hi-hat Top
- [1] 14"/36cm Zildjian Avedis New Beat Hi-hat Bottom
- [1] 22" Yamaha Absolute Bass Drum with Ahead Armor Case
- [1] 18" Yamaha Absolute Bass Drum with Ahead Armor Case
- [1] 16" Yamaha Absolute Floor Tom with Ahead Armor Case
- [1] 14" Yamaha Absolute Floor Tom with Ahead Armor Case
- [1] 12" Yamaha Absolute Tom with Ahead Armor Case
- [1] 10" Yamaha Absolute Tom with Ahead Armor Case
- [1] 14" Yamaha Absolute Snare with Ahead Armor Case
- [1] Yamaha Hi-hat Stand
- [1] DW5000 Kick Pedal
- [1] Yamaha Kick Pedal
- [1] Yamaha Tom Mount for two toms
- [1] Yamaha Snare Drum Stand
- [2] Pearl Snare Drum Stand
- [1] DW5000 Drum Throne
- [2] Pearl Cymbal Boom Stand
- [3] Yamaha Cymbal Boom Stand
- [1] Gibraltar Cymbal Boom Stand
- [3] Yamaha Cymbal Stand
- [1] Five Segment Drum Shield
- [2] 4' x 3' Drum Rug

Percussion

- [1] Adams Alpha Vibraphone
- [1] Zildjian "C to C" Crotales
- [1] Pearl Cajon
- [1] LP Udu Drum Utar
- [1] Meinl Guiro
- [1] Finger Cymbals
- [1] Treeworks Chimes
- [1] Duplex Sleigh Bells
- [1] Woodblock
- [1] Maracas

Piano/Keys

- [2] Steinway & Sons Grand Piano

- [1] Upright practice Piano
- [1] M-Audio Hammer 88 Keyboard
- [1] Kawai ES110 Digital Piano with Case
- [1] Kawai F-10H Sustain Pedal
- [1] Alesis ASP-2 Sustain Pedal
- [1] M-Audio EX-P Expression Pedal
- [1] ProLine Double Keyboard Stand
- [1] ProLine Keyboard Stand
- [2] OnStage Keyboard Stand
- [2] ProLine Keyboard Bench
- [1] OnStage Keyboard Bench

Miscellaneous

- [1] Hercules Three Guitar Stand
- [1] Hercules Guitar Stand
- [6] OnStage Guitar Stand
- [1] Full Size French Bass Bow

Appendix D – Ground Plans & Layouts
Walton Arts Center Facility – Floor Plan – Level 1

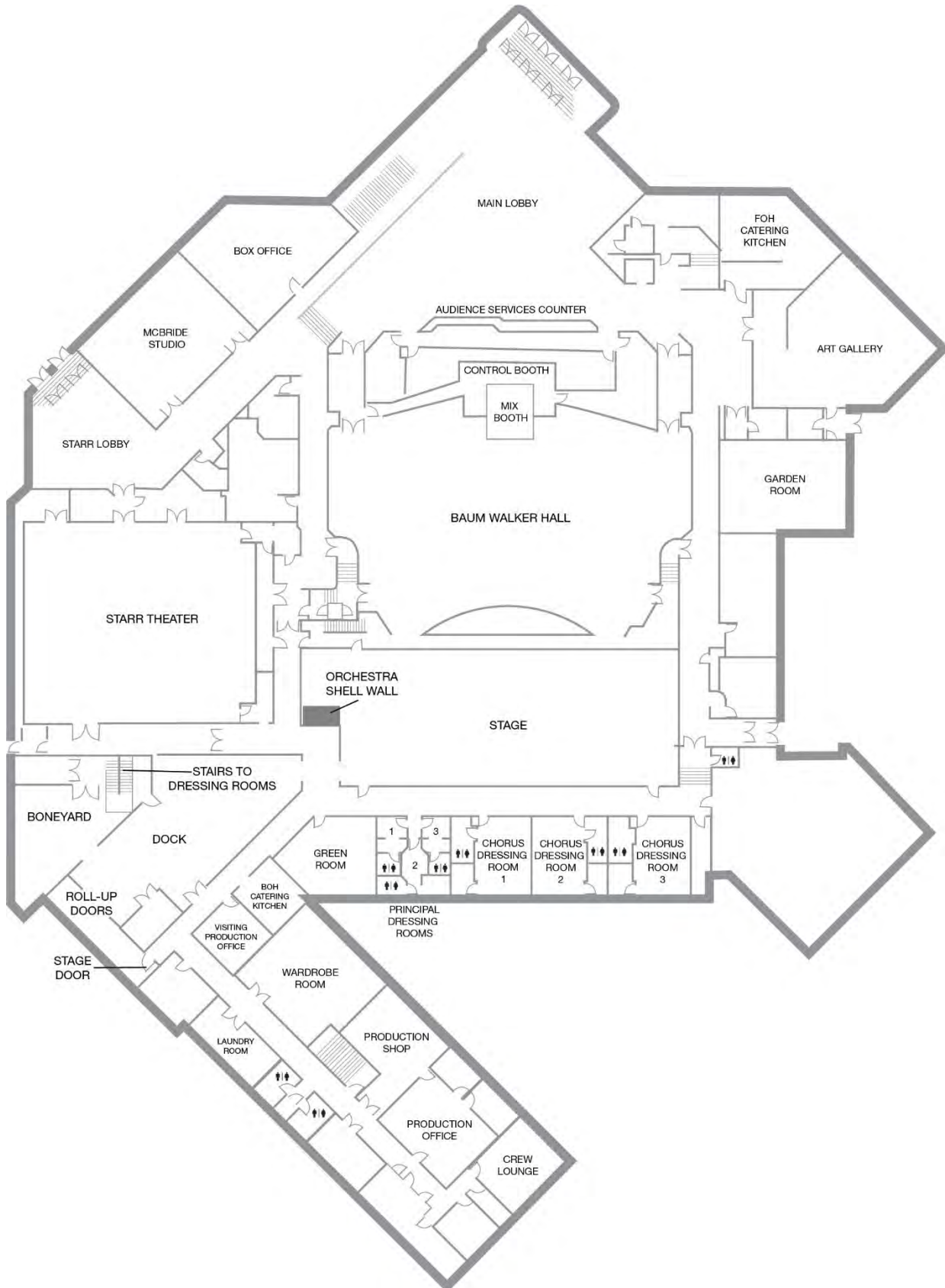

Walton Arts Center Facility – Floor Plan – Level 2

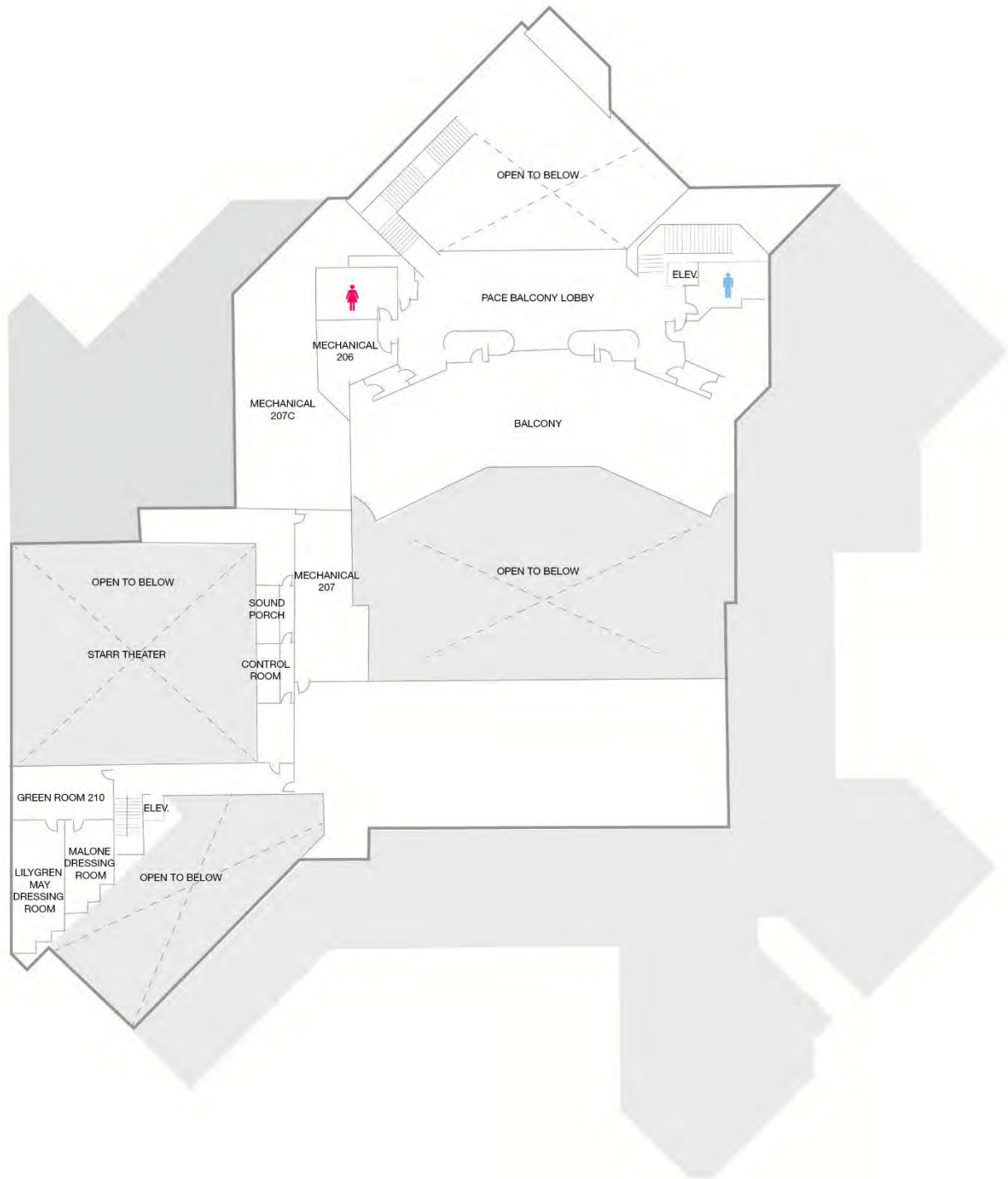

Starr Theater – Empty Layout

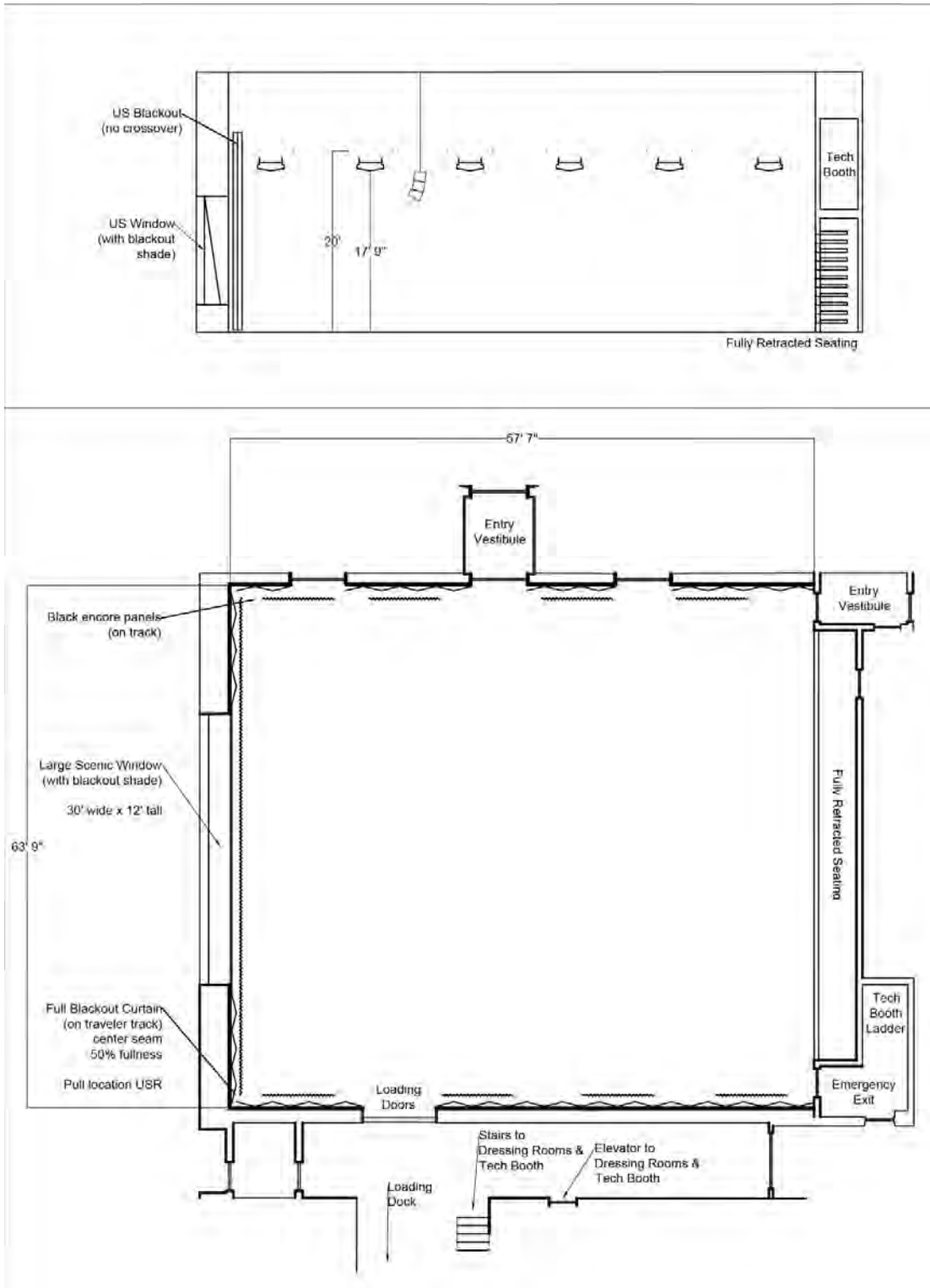

Starr Theater – Catwalk Layout

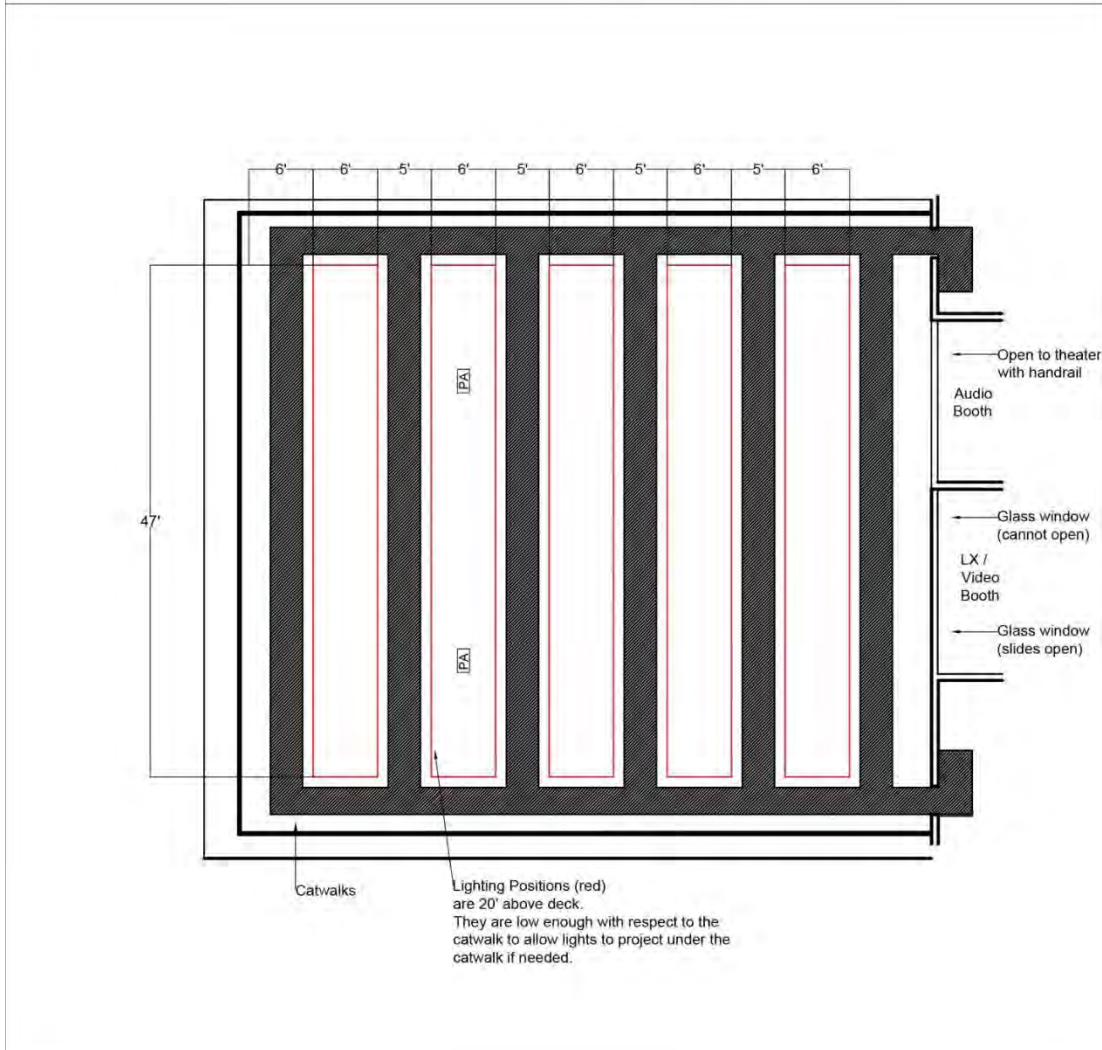
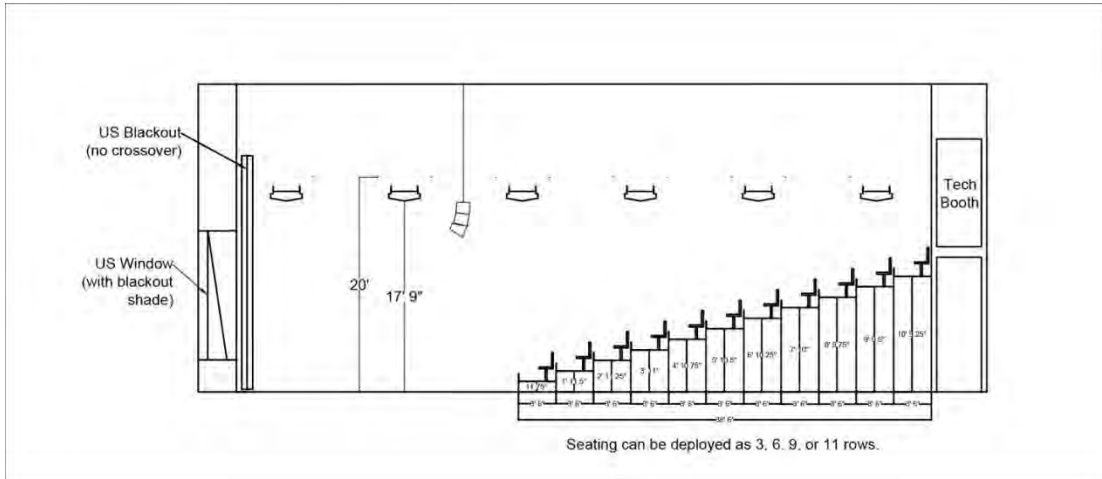

Starr Theater – Seating Layout

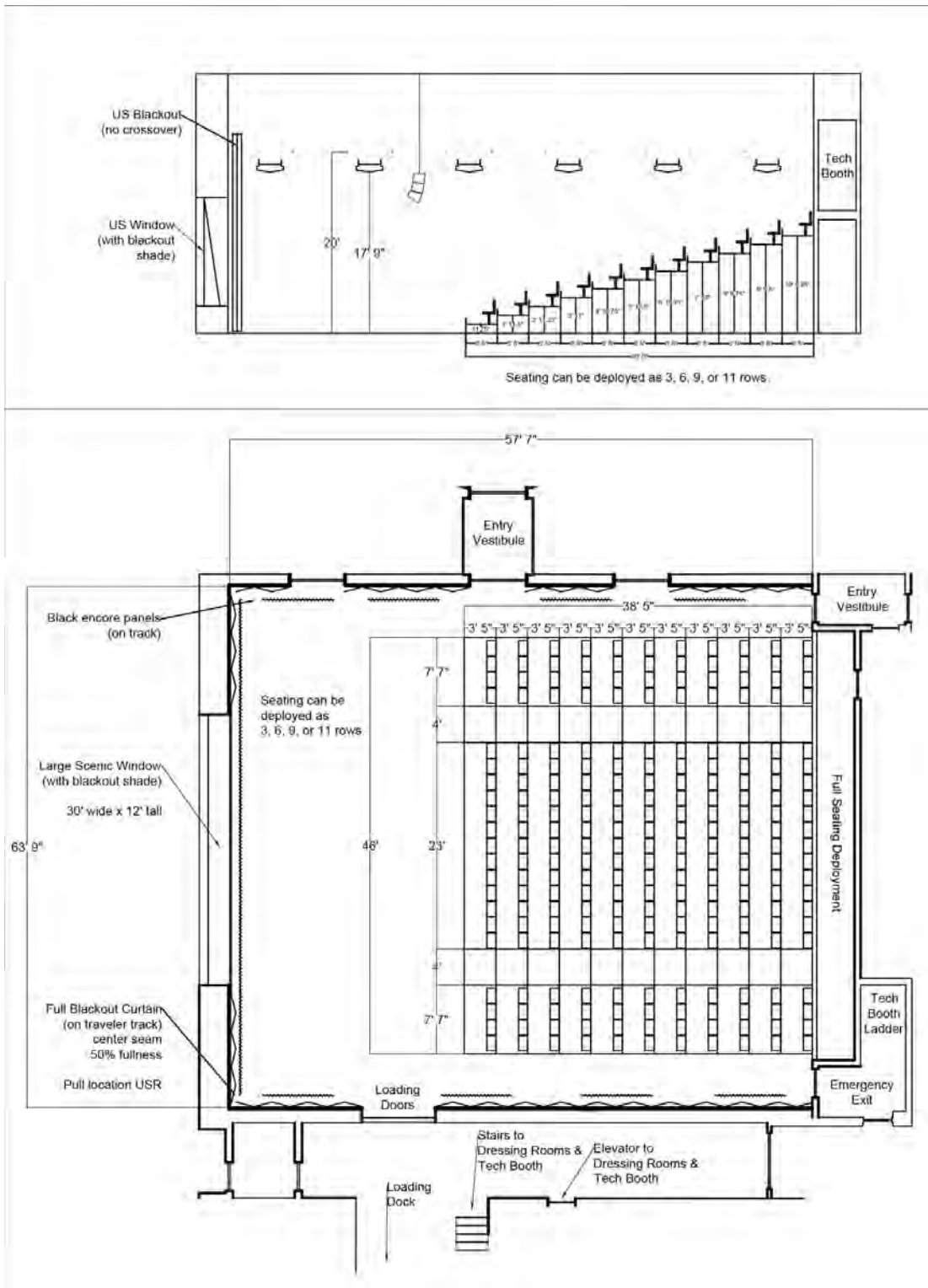

Appendix E - Photos
Venue Truck Entrance



Venue Loading Dock



Starr Theater – Stage Area



Starr Theater – Fully Deployed Seating



Starr Theater – Fully Retracted Seating



Starr Theater – Green Room



Starr Theater – Large Dressing Room



Starr Theater – Small Dressing Room



Interior Loading Dock View



Stage View from Loading Dock

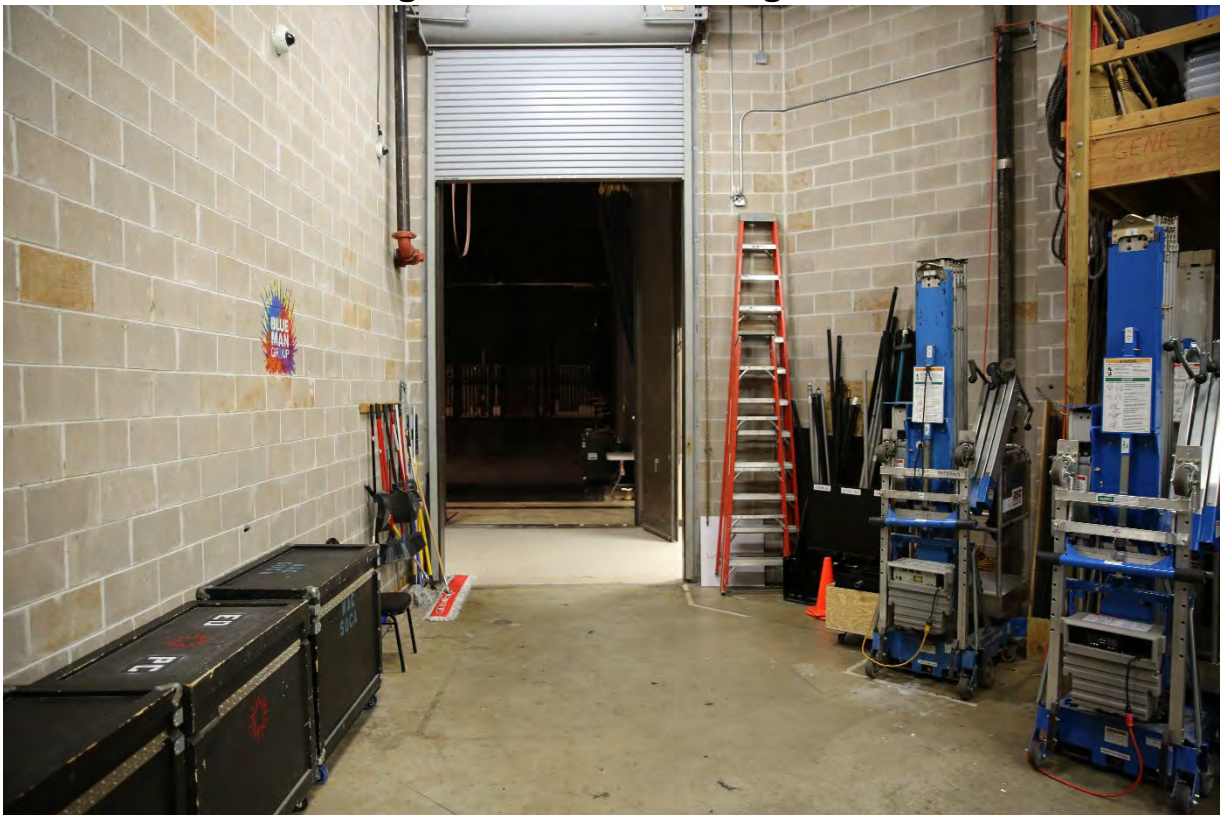

Additional Storage – “Boneyard”



“Boneyard” – Alternate View



Wardrobe Room



Laundry Room



Visiting Production Office

